

FBS SİSTEM

FBS SİSTEM

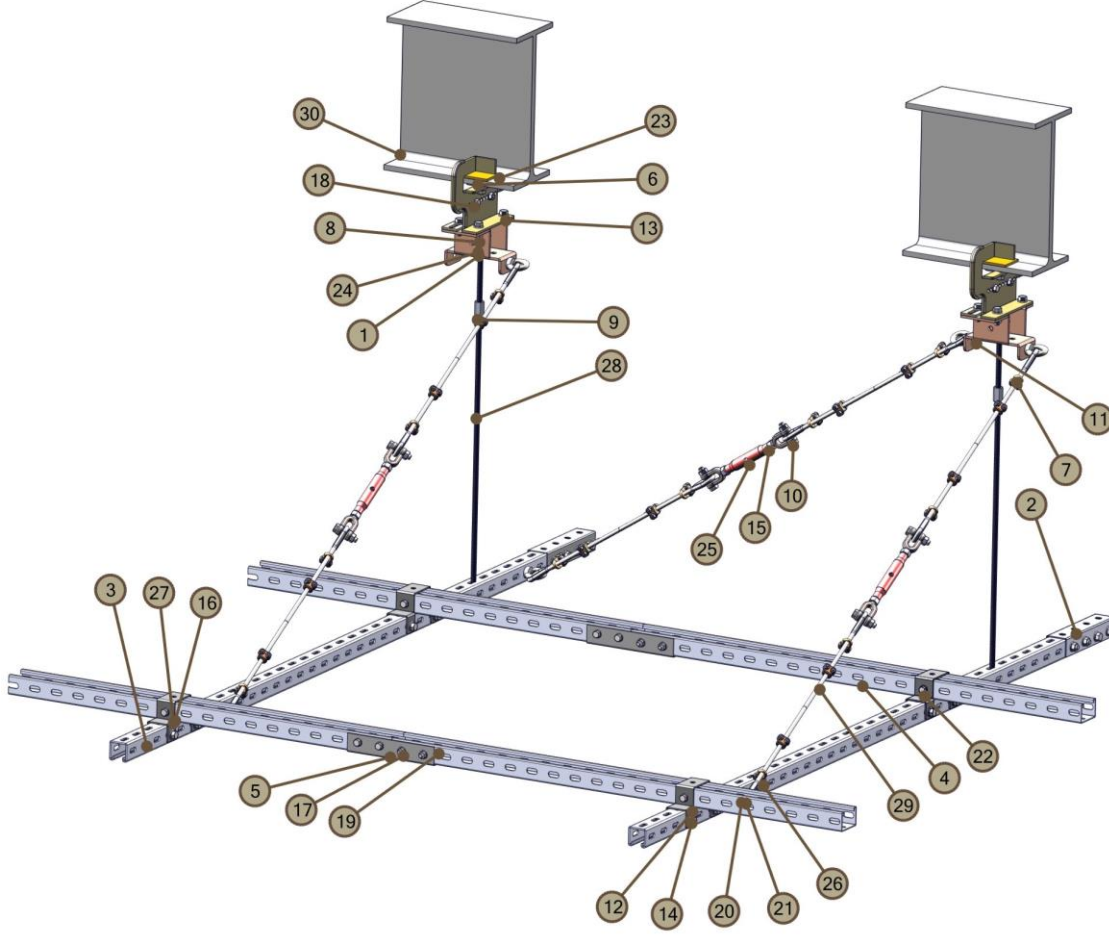

ADI	KOD
Tij Askı Parçası	1
Ana Taşıyıcı Ekleme	2
Ana Taşıyıcı	3
Tali Taşıyıcı	4
Tali Taşıyıcı Ekleme	5
Ana Kelepçe	6
Sismik Gergi Bağlantısı	7
M10 Kanat Somunu	8
M10 Tij Ekleme	9
M10 Turnbuckle Cıvata	10
M10 Turnbuckle Somun	11
M10 Somun	12
M10x25 Cıvata	13
M10x60 Cıvata	14
M12 Turnbuckle Somun	15
M6 Flanşlı Somun	16
M8 Flanşlı Somun	17
M8x20 Cıvata	18
M8x80 Cıvata	19
M10 Mapa	20
M8 Yüksük	21
Ana-Tali Taşıyıcı Bağlayıcı	22
Sismik Pad	23
Gasket	24
Mapa	25
M6 Somun	26
M6x15 Cıvata	27
M10 Tij	28
8 mm Çelik Tel	29
Çatı Çelik Profili	30

- Bina tipi nedeniyle asma tavan sistemine uygun bir askı noktası bulunmadığında, FBS proje için doğru üründür.
- FBS sistemi ayrıca MEP ve IT bileşenlerini taşımak üzere tasarlanabilir.
- Çatı çelik konstrüksiyon sisteminden asılı noktalar oluşturmak için 8 m mesafeye kadar açıklık patentli kelepçelerle geçmek mümkündür.

GÖRÜNÜŞ

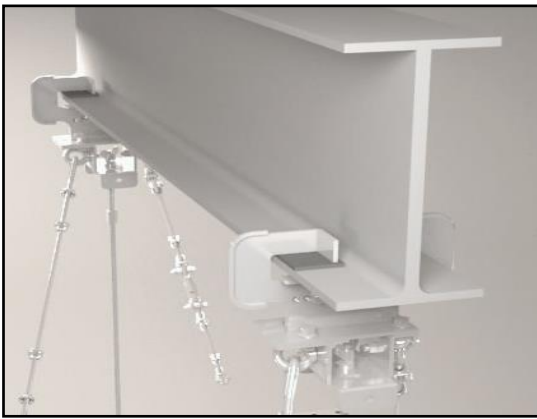
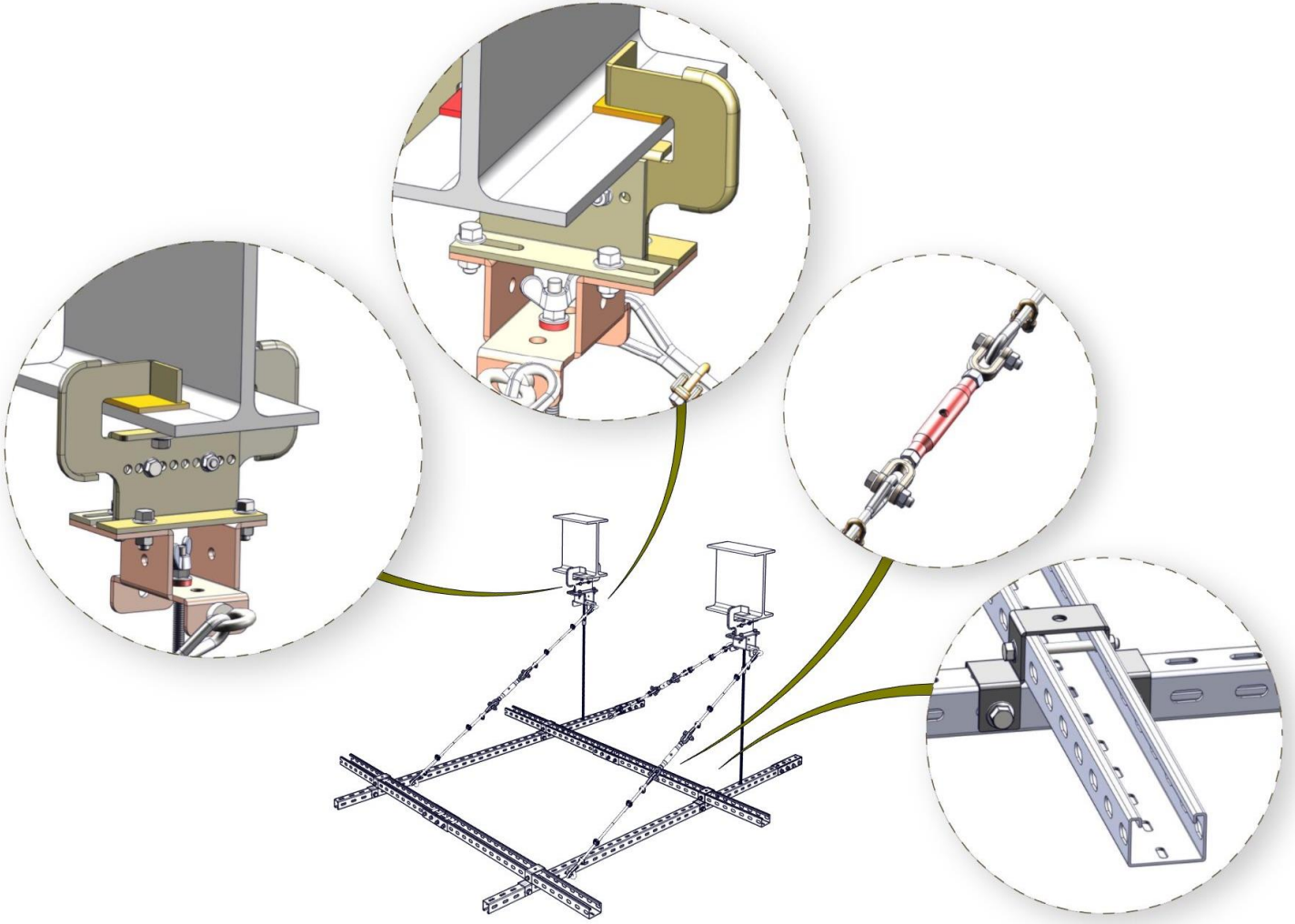

PANEL MALZEME SEÇENEKLERİ

Galvaniz Çelik

NEM / HUMIDITY

Galvaniz panel : 90% RH
Alüminyum panel : 100 % RH

BOYA

Boya öncesinde, hassas yüzey temizliği ve fosfat kaplaması uygulanır. 6 robot kolu elektro static system sayesinde minimum 60 mikron boya panele uygulanır ve 180 mt uzunluğundaki fırında pişirilir. Tüm boyama işlemi otomatik olarak bilgisayar kontrolünde gerçekleşir.

SİSTEM PARÇALARI ÖZELLİKLERİ

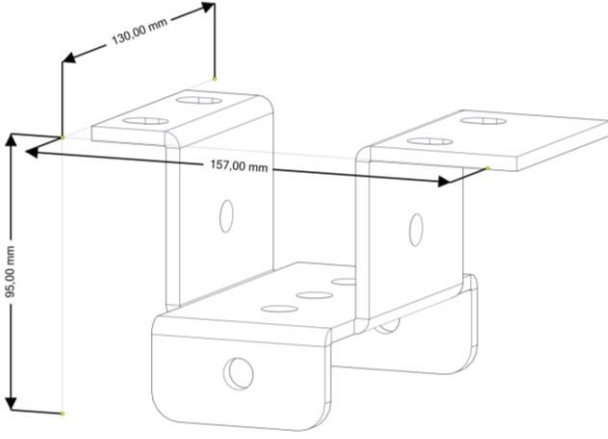
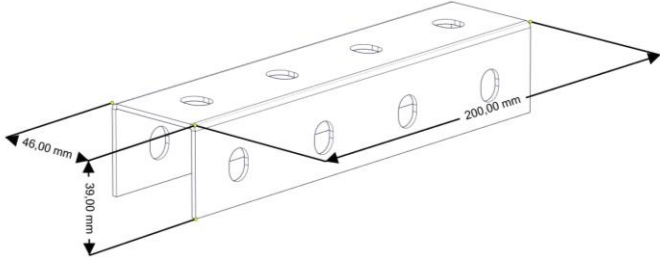
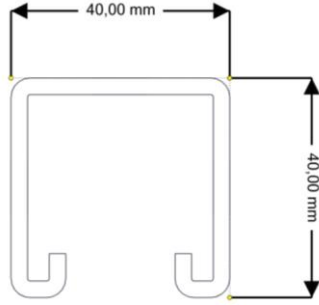
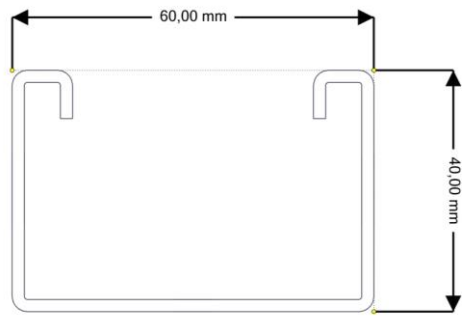
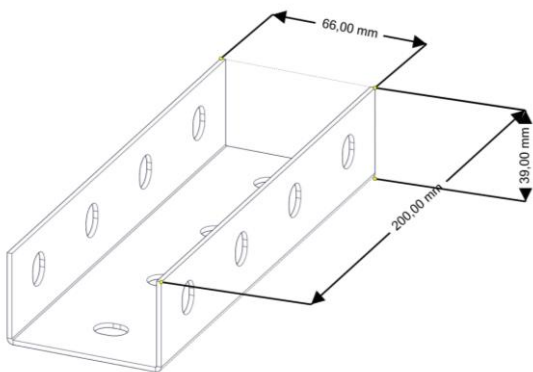
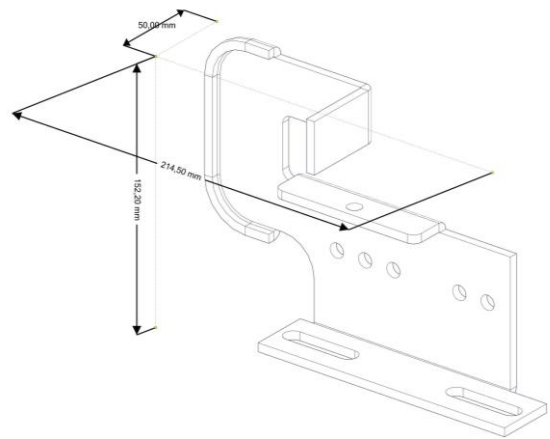
<p>1. Tij Askı Parçası</p> 	<p>2. Ana Taşıyıcı Ekleme</p> 
<p>T : 5 mm Galvaniz Çelik</p>	<p>T : 2 mm Galvaniz Çelik</p>
<p>3. Ana Taşıyıcı</p> 	<p>4. Tali Taşıyıcı</p> 
<p>T : 3 mm Galvaniz Çelik L : up to 6000 mm</p>	<p>T : 2 mm Galvaniz Çelik L : up to 6000 mm</p>
<p>5. Tali Taşıyıcı Ekleme</p> 	<p>6. Ana Kelepçe</p> 
<p>T : 2 mm Galvaniz Çelik</p>	<p>T : 5 mm Galvaniz Çelik</p>

7. Sismik Gergi Bağlantısı

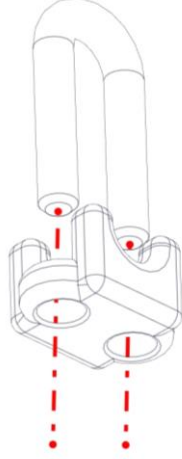

8. M10 Kanat Somunu



T : Galvaniz Çelik

T : Galvaniz Çelik

9. M10 Tij Ekleme

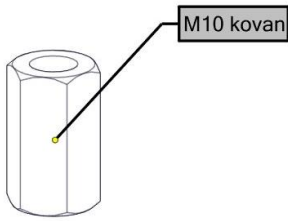

10. M10 Turnbuckle Cıvata

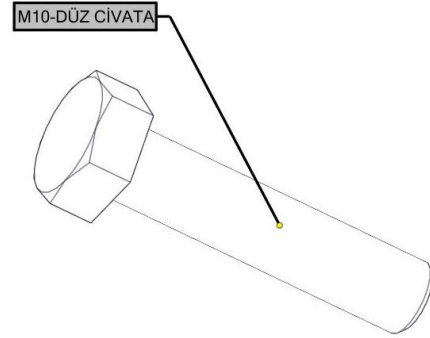

T : M10 Galvaniz Çelik

T : M10 Cıvata Çelik

11. M10 Turnbuckle Somun

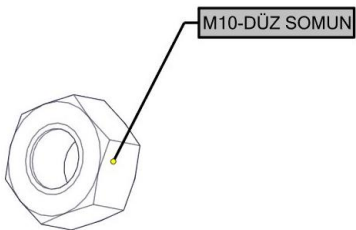

12. M10 Somun

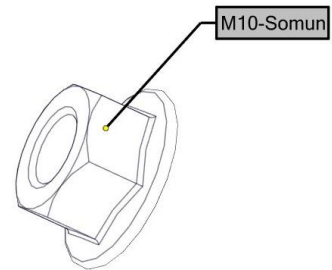

T : M10 Somun Çelik

T : M10 Somun Çelik Galvanized

13. M10 X 25 Bolt

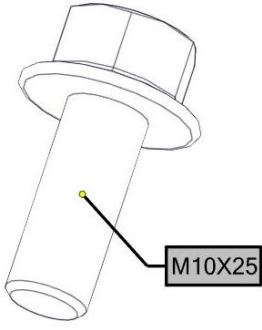

T : M10 x 25 Çelik

14. M10 X 60 Bolt

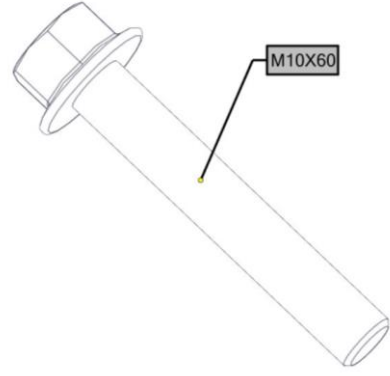

T : M10 x 60 Çelik

15. M12 Turnbuckle Somun

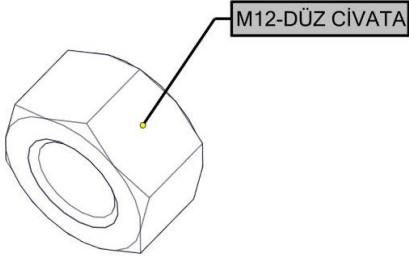

T : M12 Somun Çelik

16. M6 Flaşlı Somun

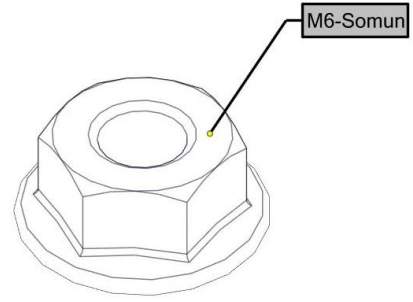

T : M6 Somun Çelik

17. M8 Flaşlı Somun

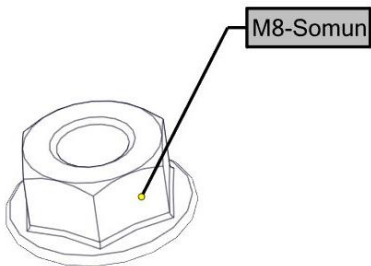

T : M8 Somun Çelik

18. M8 x 20 Cıvata

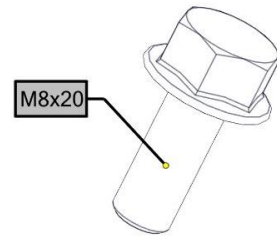

T : M8 x 20 Cıvata Çelik

19. M8 X 80 Cıvata

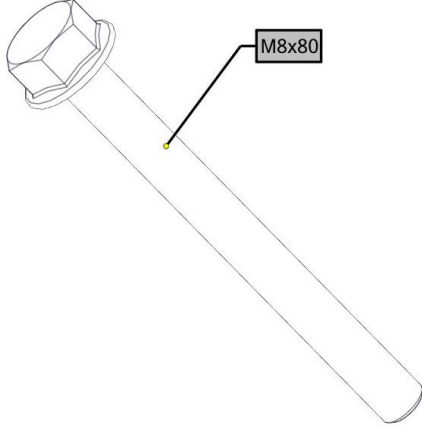

T : M8 X 80 Cıvata Çelik

20. M10 Mapa

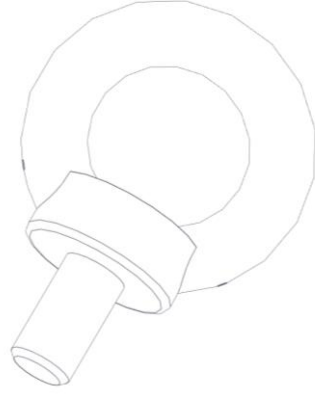

T : Çelik

21. M8 Yüksük

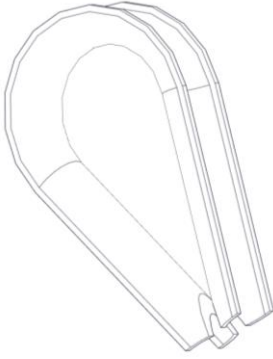

T : Galvaniz Çelik

22. Ana-Tali Taşıyıcı Bağlayıcı

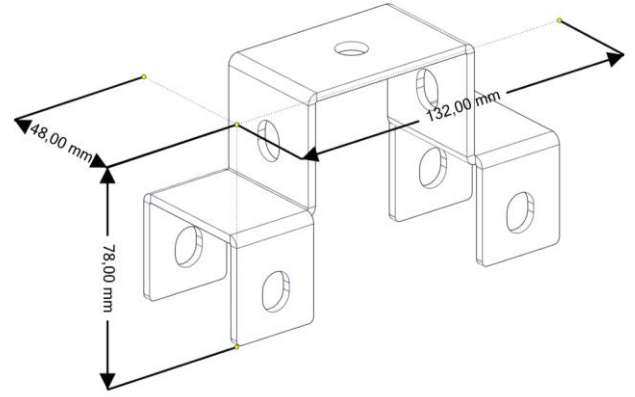

T : 2 mm Galvaniz Çelik

23. Sismik Pad

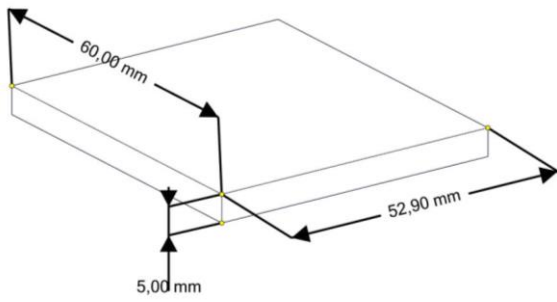

T : 5 mm Pad

24. Gasket

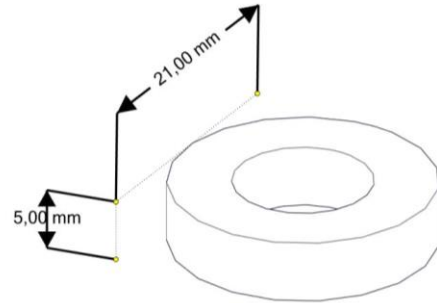

T : 5 mm Galvaniz Çelik

25. Mapa

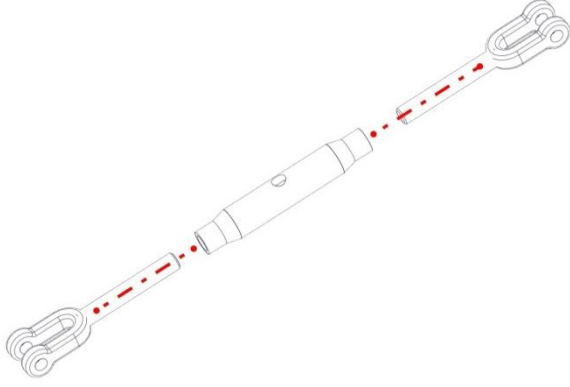

T : Galvaniz Çelik

26. M6 Somun

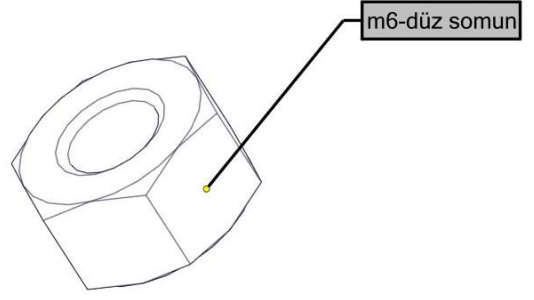

T : M6 Hex- Somun Çelik

27. M6 X 15 Cıvata

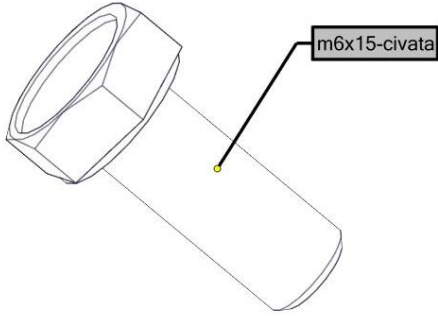

T : M6 X 15 Cıvata Çelik

28. M10 Tij



T : M10 Tij Çelik

29. 8 mm Çelik Tel



T : 8 mm Galvaniz Çelik

30. Çatı Çelik Profili

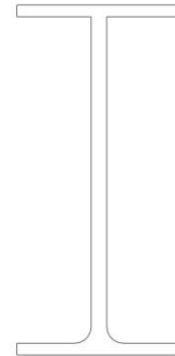

Çatı Çelik Profili

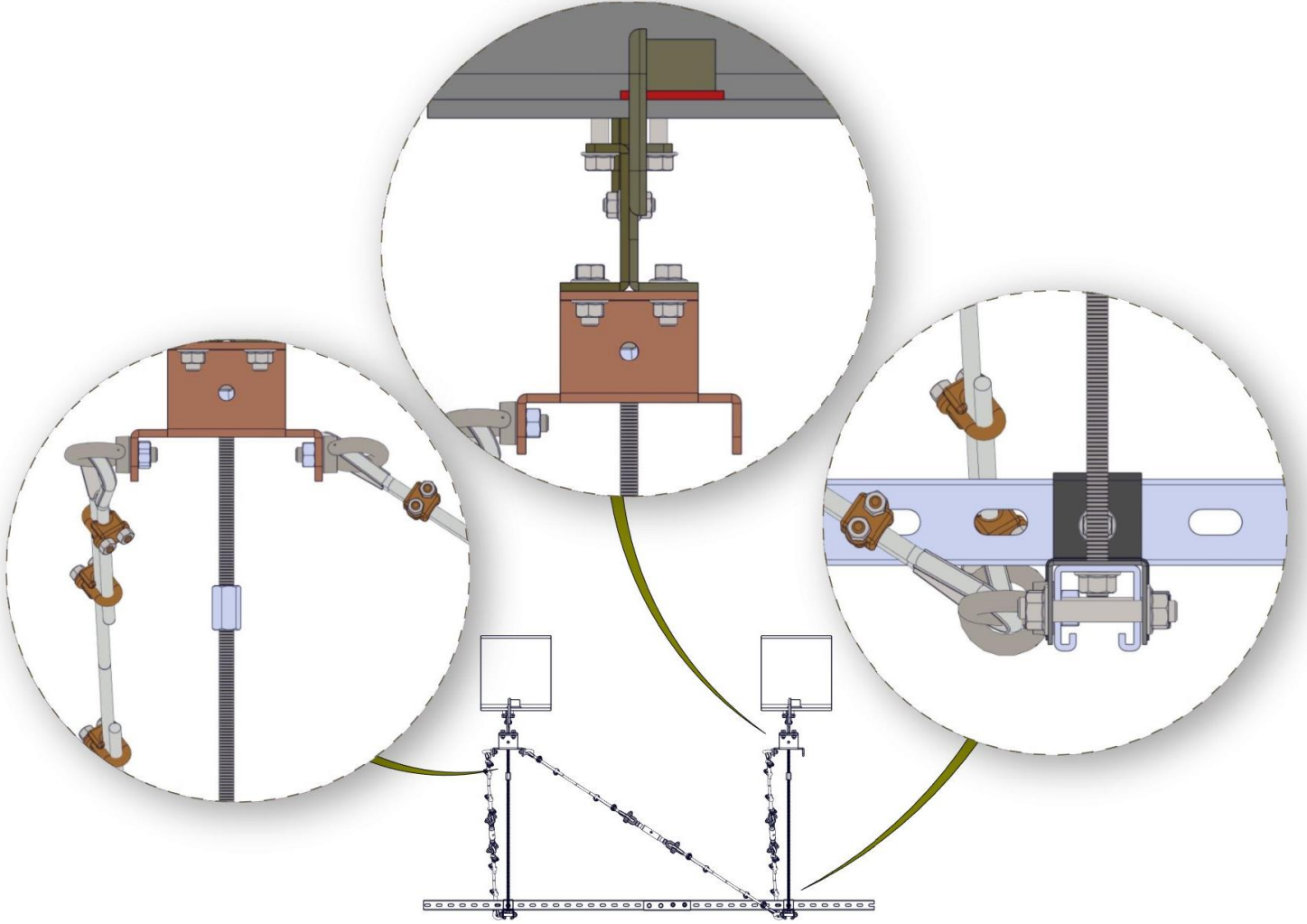

FBS Sistem Ayrıntıları

1. FBS, bina yapısına kaynak ve vidalama ile bağlantı kurulmasına izin verilmediği, koşullar için bir çözüm getirmektedir.
2. FBS Sistemi% 35'e kadar malzeme maliyetinde tasarruf sağlar.
3. FBS Sistemi, işçilik maliyetinde% 35'e kadar tasarruf sağlar..

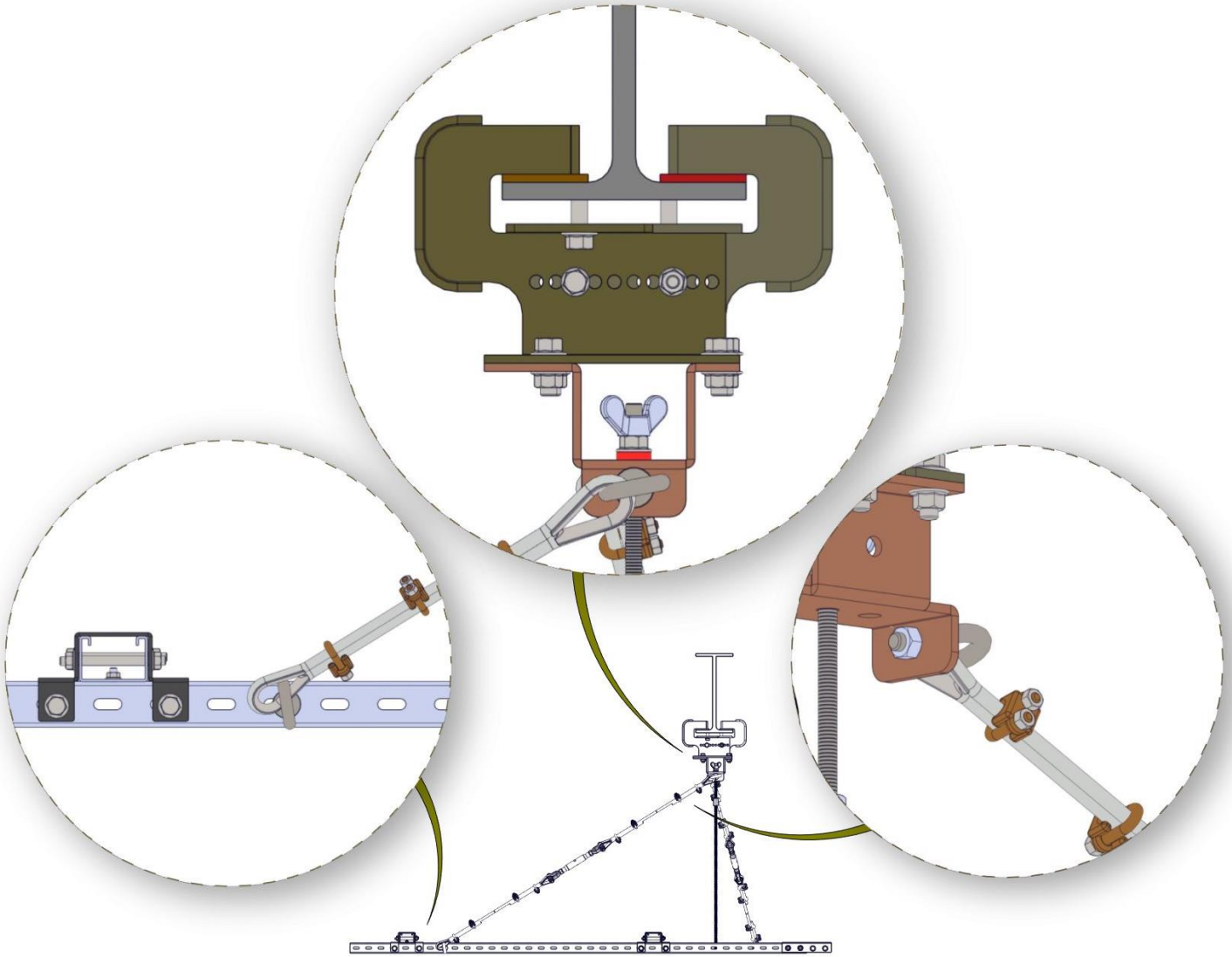

4. FBS Sistemi, alışlagelmiş kutu profil yöntemlerine kıyasla m² başına yükte % 45 tasarruf sağlar.
5. FBS Sistemi civata ve somun bağlantısı nedeniyle montajda zaman kazandırır.
6. Kaynak, paslanma ve rötuşla ilgili maliyet yoktur.

UYGULAMA TEKNİĞİ

ADIM 1.

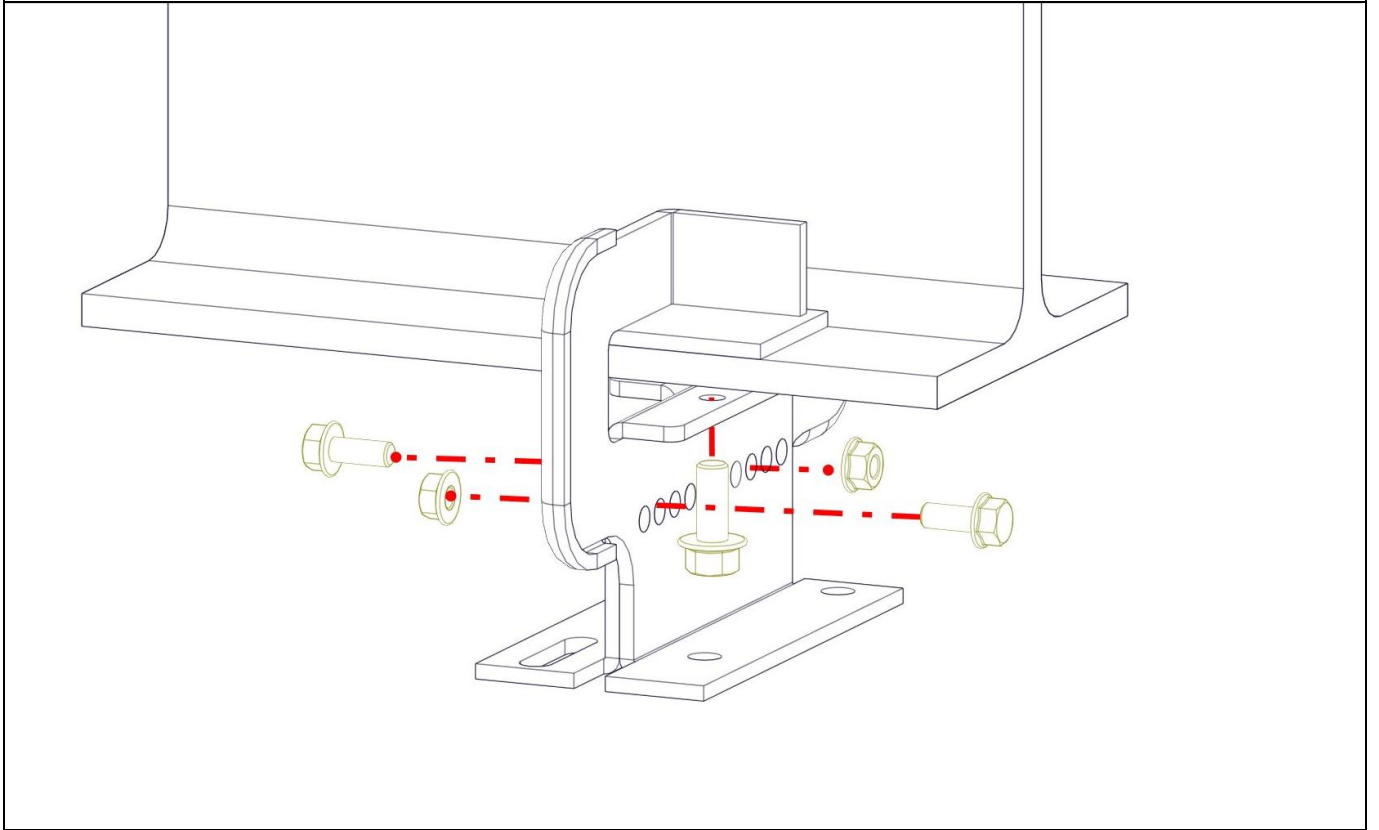
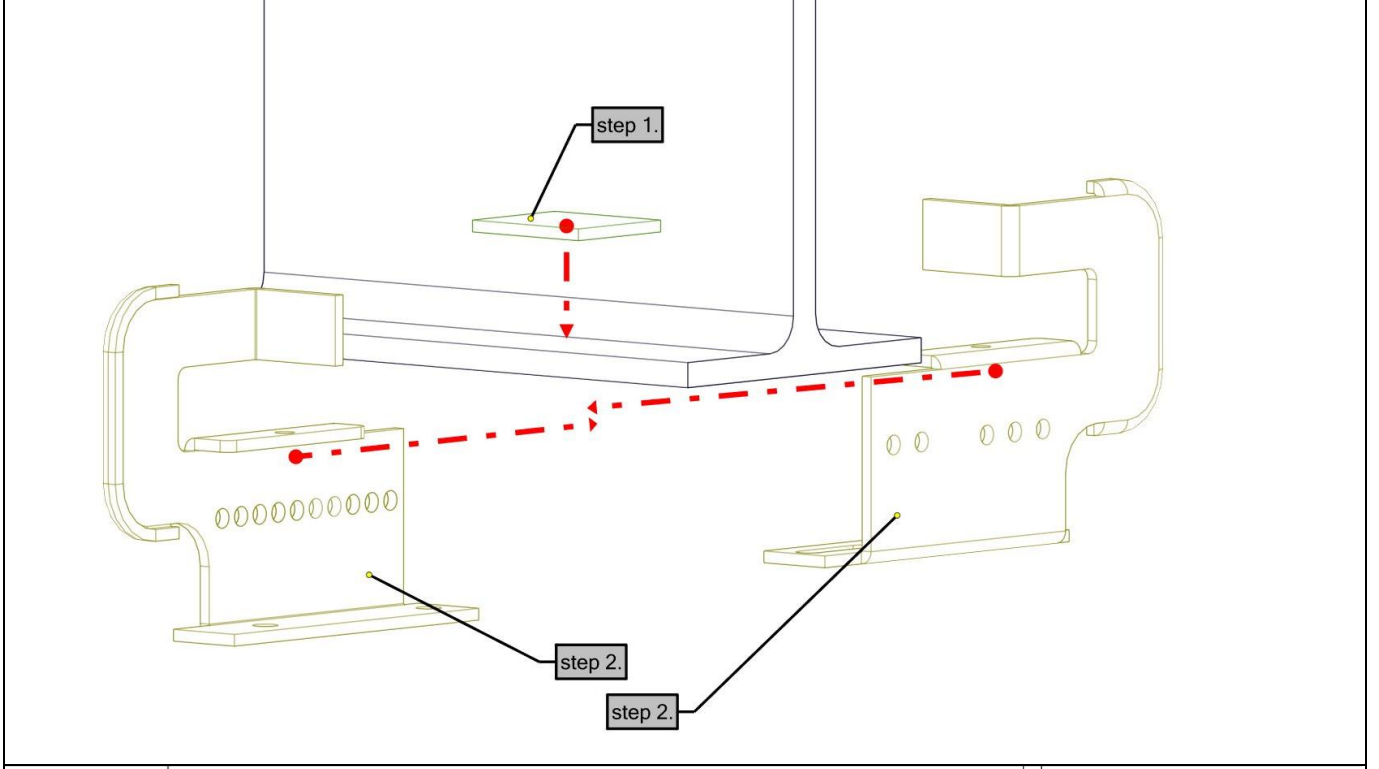

ADIM 2.

ADIM 3.

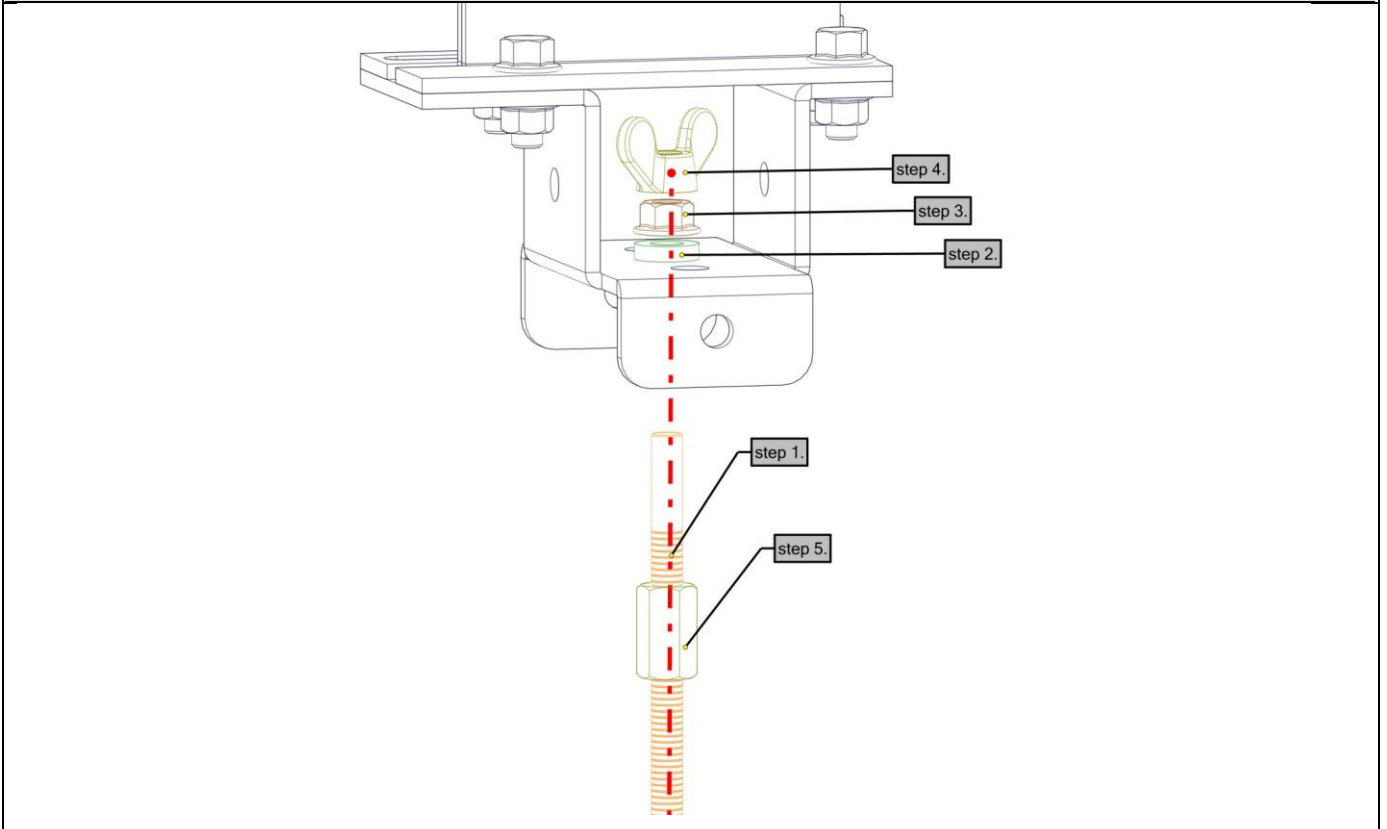
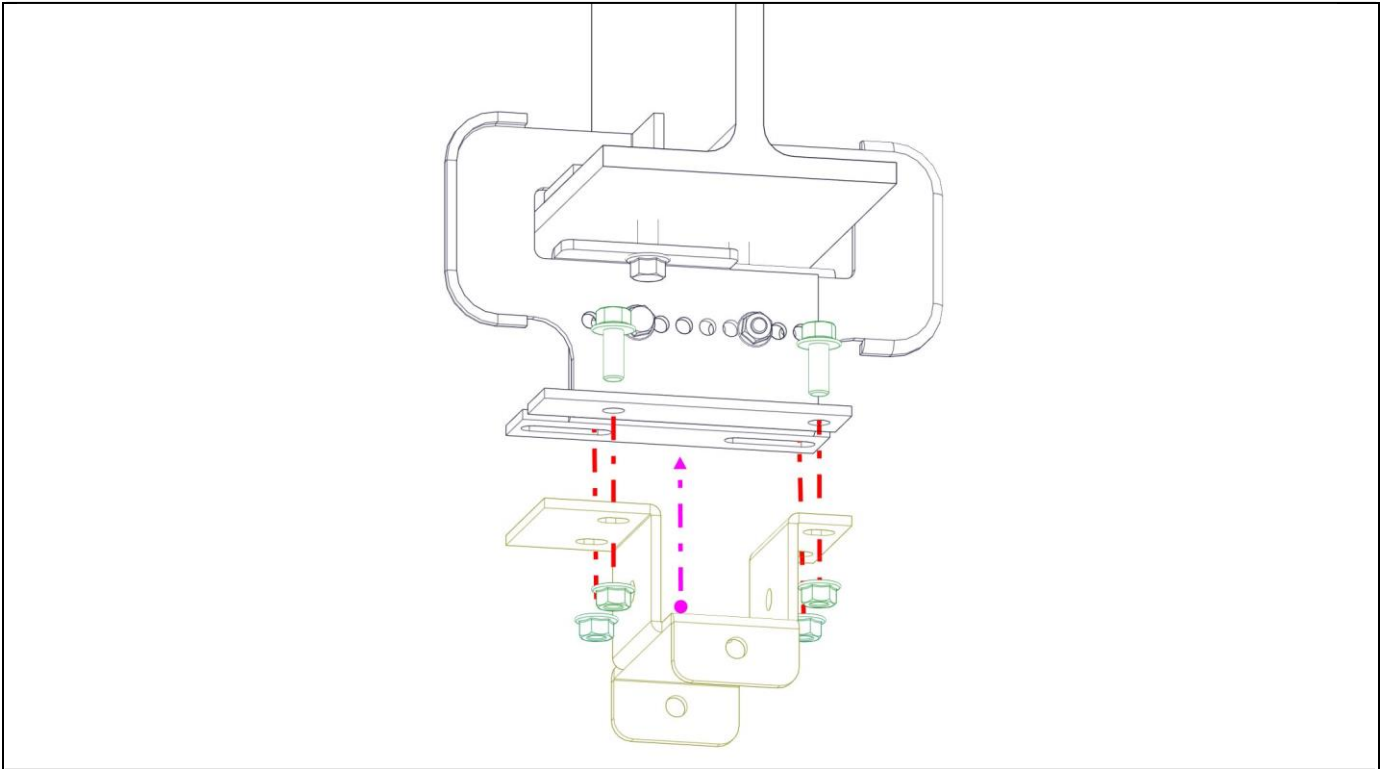

ADIM 4

ADIM 5.

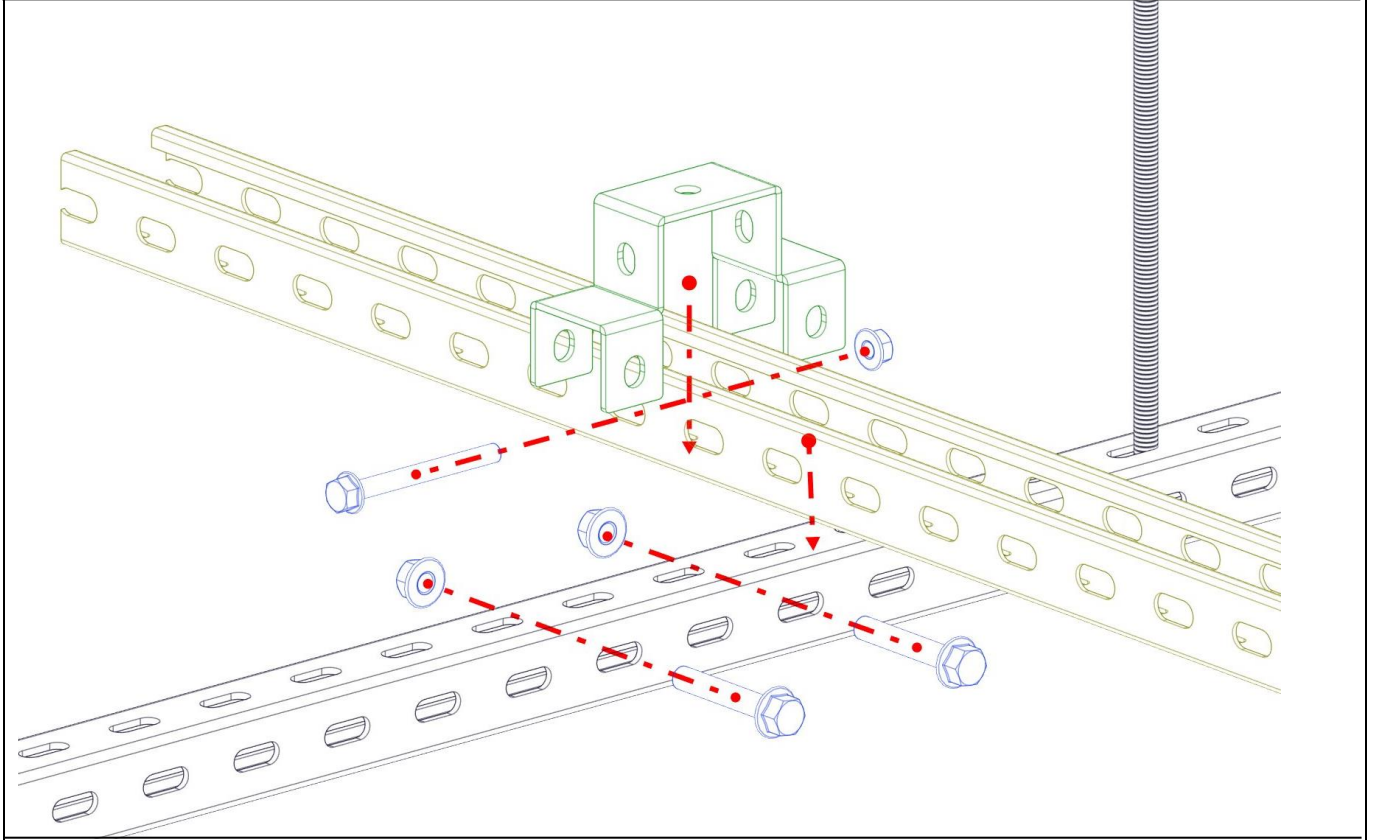
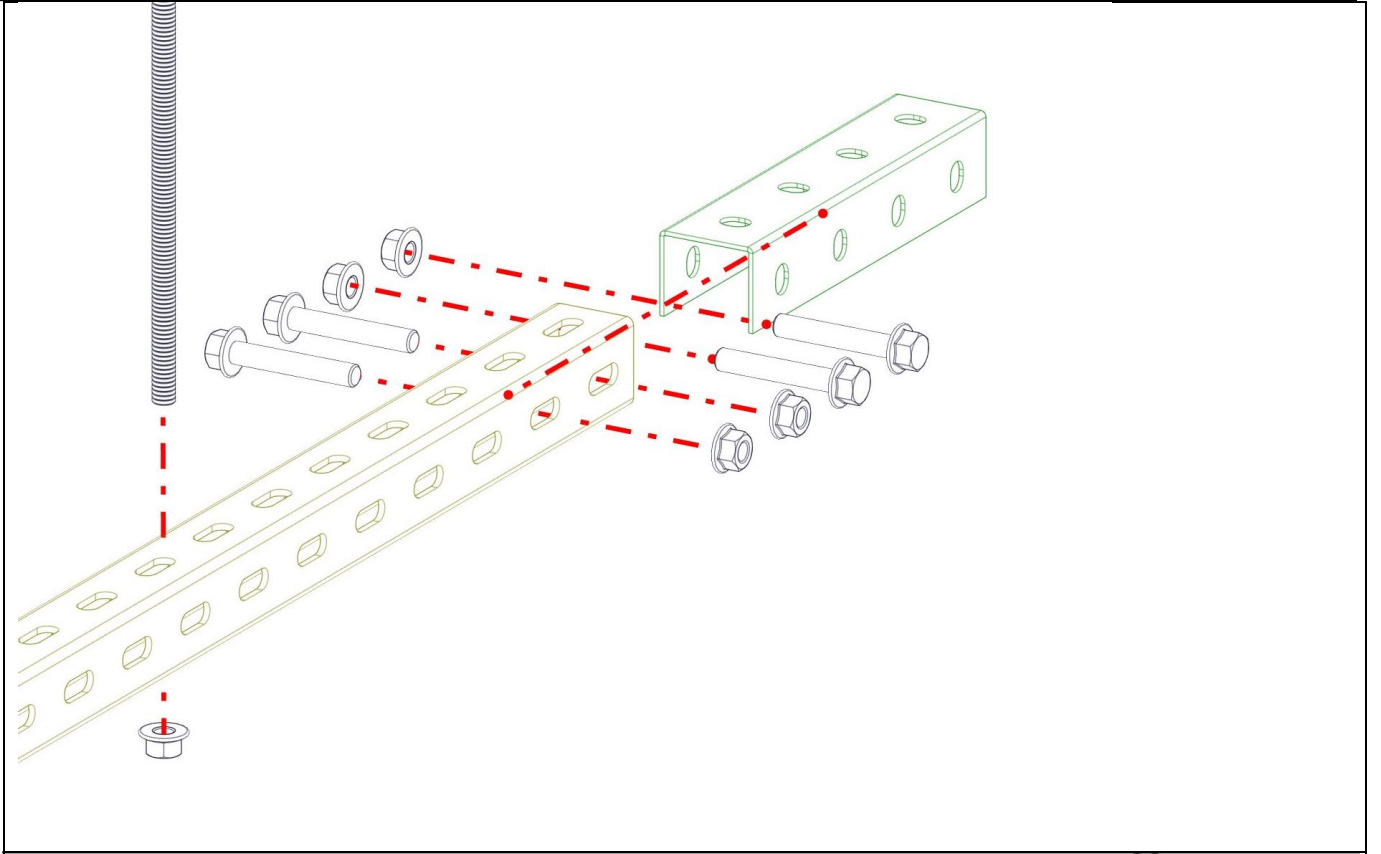

ADIM 6.

ADIM 7.

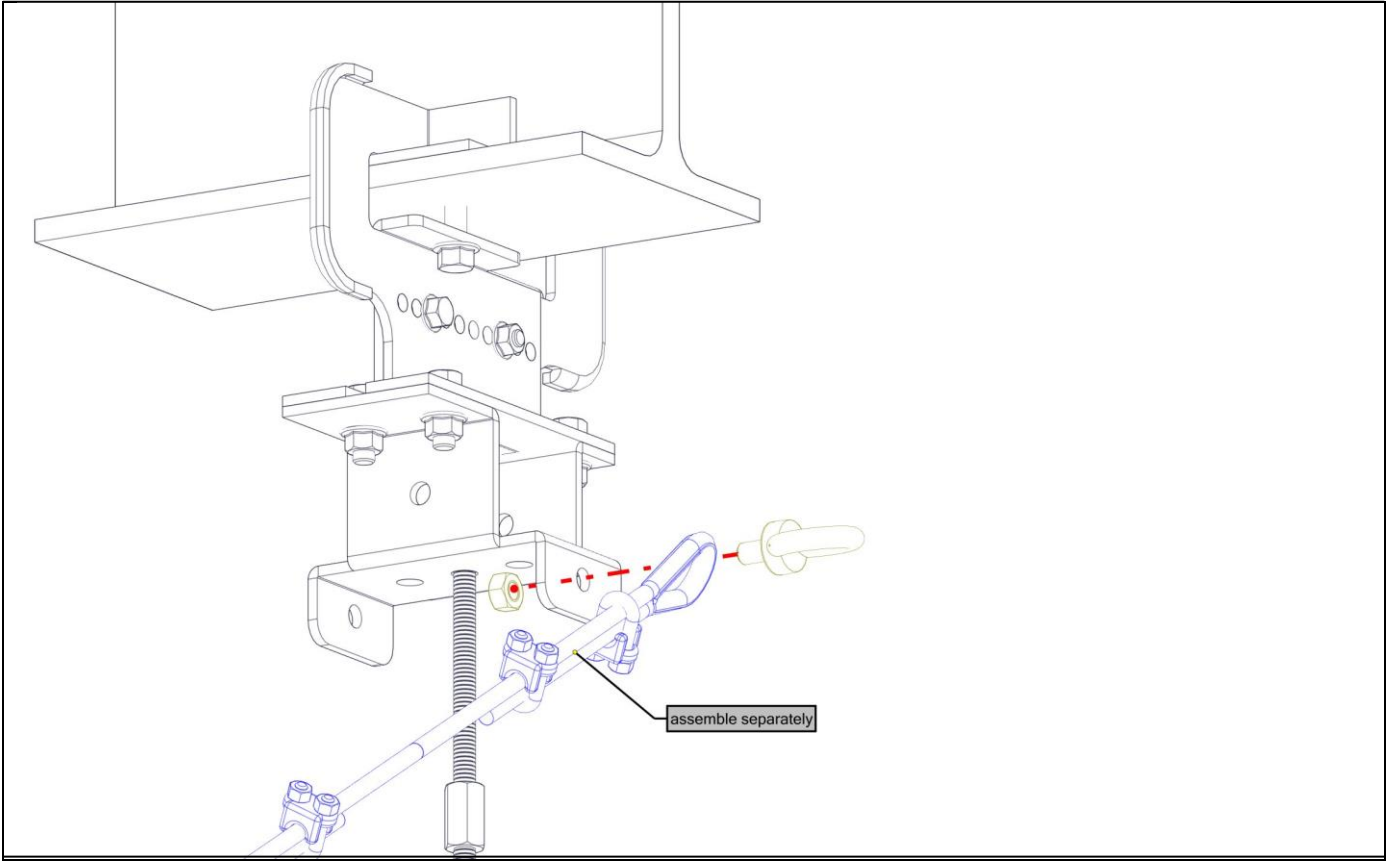

Declaration of Performance

No:A-INT.PD20171001-01



1. Unique identification code of the product-type:	"BUTEM" Metal Ceiling Systems
2. Type, batch or serial number or any other element allowing identification of the construction product as required pursuant to Article 11 (4):	Product Type, Order/Batch Nr.
3. Intended use or uses of the construction product, in accordance with the applicable harmonized technical specification, as foreseen by the manufacturer:	Internally, to produce an installed suspended ceiling
4. Name, registered trade name or registered trade mark and contact address of the manufacturer as required pursuant to Article 11 (5):	BÜTEM METAL FORM SANAYİ TİCARET A.Ş. Osman Gazi Mahallesi Ziya Gökalp Caddesi No:10 Esenyurt Istanbul Turkey T:+90 (212)886 33 00 F:+90 (212) 886 33 10 www.butemmetal.com.tr
5. Where applicable, name and contact address of the authorized representative whose mandate covers the tasks specified in Article 12 (2):	Not Applicable
6. System or systems of assessment and verification of constancy of performance of the construction product as set out in Annex V:	Systems 3
7. In case of the declaration of performance concerning a construction product covered by a harmonized standard:	(a) The manufacturer carrying out factory production control; (b) Turkish Standards Institution (TSE) /Notified Body No:1783 issued the Reaction to Fire classification report (Report No:TSE-19.01.2017-170050) according to TS EN 13501-1+A1:2013-04 as the notified testing laboratory (based on sampling carried out by the manufacturer).
8. In case of the declaration of performance concerning a construction product for which a European Technical Assessment has been issued:	Not Applicable

Declaration of Performance

No:A-INT.PD20171001-01



9.Declared Performance

- (a) Column 1 shall contain the list of essential characteristics as determined in the harmonized technical specifications for the intended use or uses indicated in point 3 above.
- (b) For each essential characteristic listed in column 1 and in compliance with the requirements of Article 6, Column 2 shall contain the declared performance, expressed by level or class, or in a description, related to the corresponding essential characteristics. The letters 'NPD' (No Performance Determined) shall be indicated where no performance is declared.
- (c) For each essential characteristic listed in column 1, column 3 shall contain:
- I-Dated reference of the corresponding harmonized standard and, where relevant, the reference number of the Specific or Appropriate Technical Documentation used; or
 - II-Dated reference of the corresponding European Assessment Document where available and reference number of the European Technical Assessment used.

Essential Characteristics	Performance	Harmonized Technical Specification
Reaction To fire	A2-s1, d0	TS EN 13964:2014-04 + TS EN13501-1+A1:2010
Release of Dangerous Substances	No Content	TS EN 13964:2014-04 + TS EN13501-1+A1:2010
Flexural Tensile Strength	NPD	TS EN 13964:2014-04 + TS EN13501-1+A1:2010
Thermal Conductivity	NPD	TS EN 13964:2014-04 + TS EN13501-1+A1:2010
Durability	Corrosion Class B	TS EN 13964:2014-04 + TS EN13501-1+A1:2010
Sound Absorption Single Value a_w	See Table Below	TS EN 13964:2014-04 + TS EN13501-1+A1:2010

Sound Absorption Single Value a_w	Perforation Types		
	Ø1,5 mm	Ø1,8 mm	Ø2,5 mm
JM 60	-	0,35	0,35
Royalin R6/60	0,60		
JM 60 Double	0,45		
JM60 with 25 mm 50 kg/m ³ rockwool	1,00		

10.The performance of the product identified in point 1 and 2 is in conformity with he declared performance in point 9.

This declaration of performance is issued under the sole responsibility of the manufacturer identified in point 4.